

# Panels

## Panel TGS B-15 [50 mm]

The panel TGS B-15 is a dividing panel system employing a dovetail joint system, which is mainly used as a partition wall and where its discrete elegant joining system enables it to be employed in practically any type of construction with very high demands and performances.

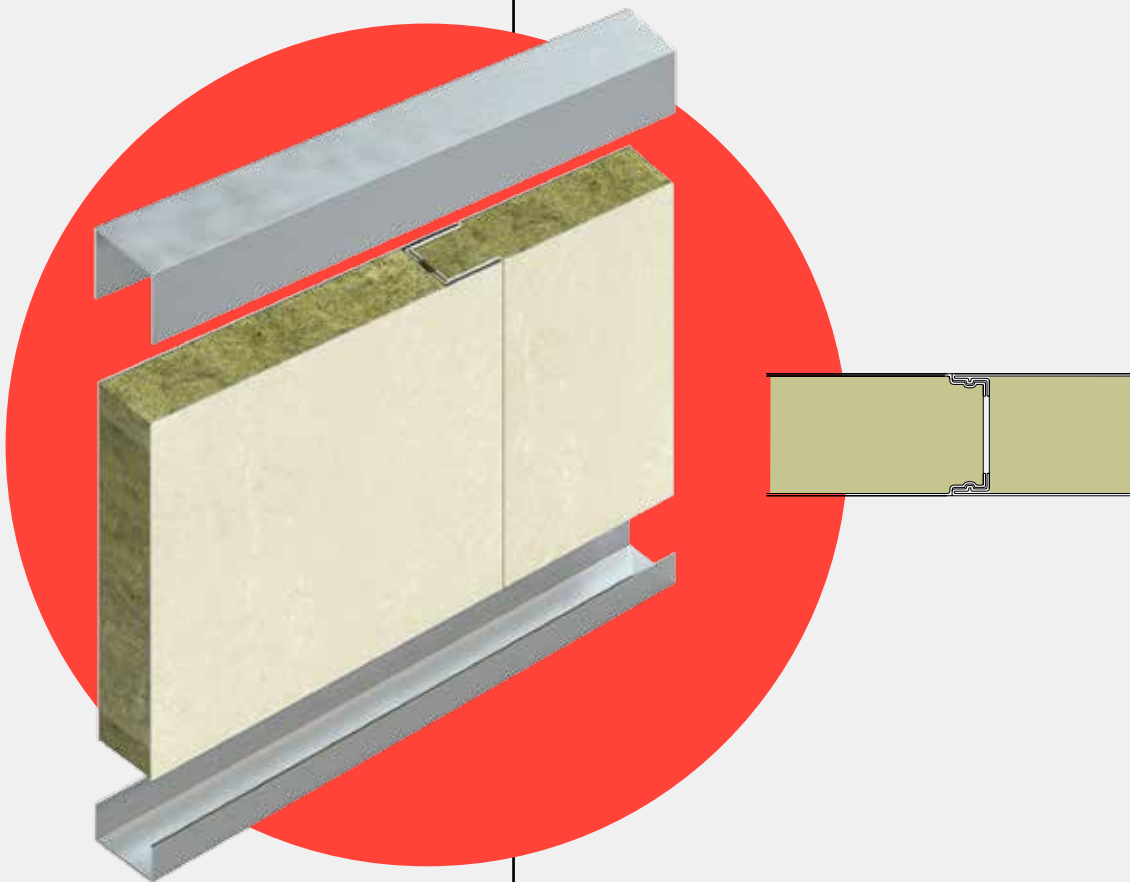

### TGS B-15

Fire classification

Standard width

Maximum length

Width

Thickness

Weight

Acoustic insulation

Thermal insulation

Application

B-15

558 mm

Up to 5.000 mm

200-1.188 mm

50 mm

16.12 Kg/m<sup>2</sup>

Rw=36 dB

U=0,6 W/m<sup>2</sup> K

Lining and division



# Assembly instructions

- 1 The perimeter outlines are fixed on the floor and the upper vertical outlines on the ceiling. They will determine the securing guide for the bulkhead made up of the panels. These profiles will be secured by alternate spot welding every 200 mm.
- 2 The first panel will be installed following the established movement sequence.
- 3 The contiguous panel will be installed the same way as the previous one, completely tangential to the previous one at the profiled edges and completely glued.
- 4 The two panels will be joined with the CLIP, which is inserted with gentle pressure, the male on the narrow section of the contiguous panel [female].
- 5 Steps 3 and 4 are repeated until the surface to cover is completed.

## Fastening examples

We can make any type of fastening, according to the client's requirements.

