

Panels

Panel clip PC A-60

As with the similar PC B-30, the PC A-60 is a 100 mm thick dividing panel with a fastening system on both faces. This panel is employed in constructions in which the insulation levels required by the administration are very high.

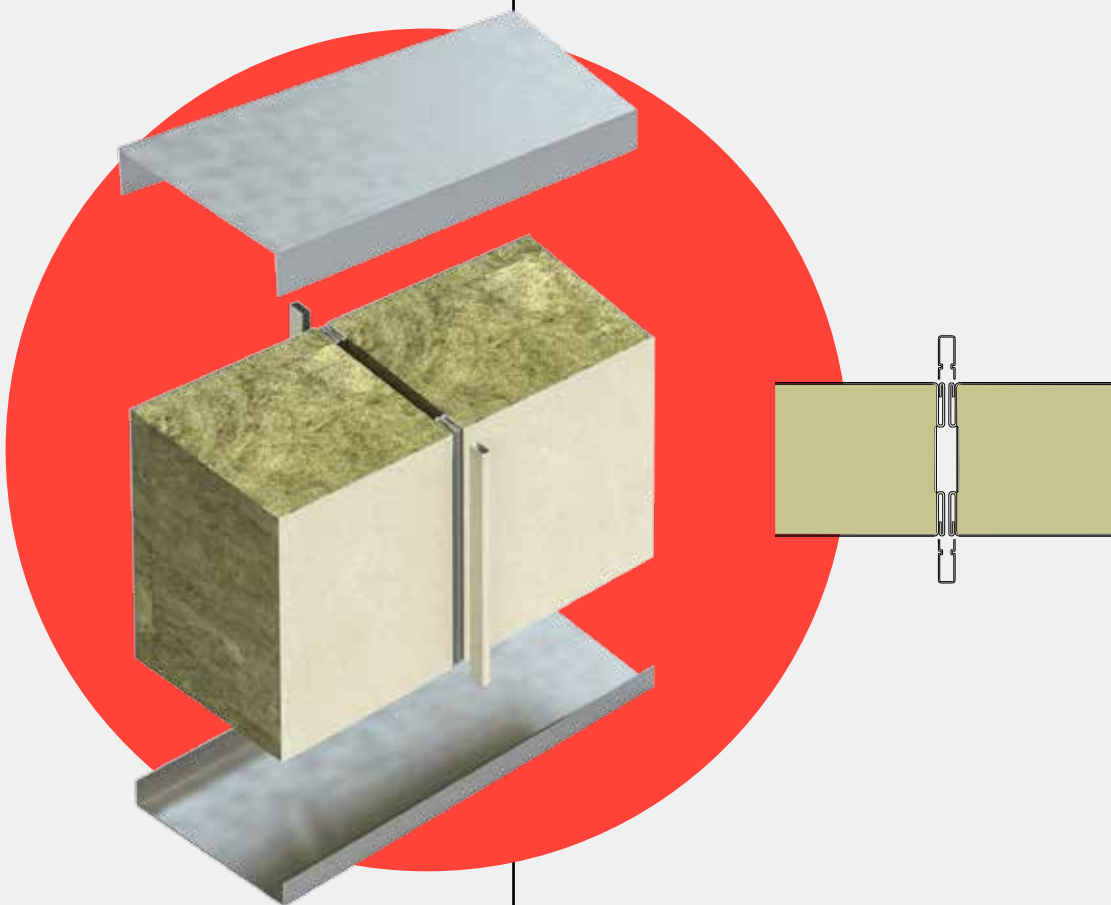

PC A-60

Fire classification	A-60
Standard width	558 mm
Maximum length	Up to 5.000 mm
Width	200-1.188 mm
Thickness	100 mm
Weight	22.12 Kg/m ²
Acoustic insulation	Rw=40 dB
Thermal insulation	U=0.48 W/m ² K
Application	Lining and division



Assembly instructions

- 1 The perimeter outlines are fixed on the floor and the upper vertical outlines on the ceiling. They will determine the securing guide for the bulkhead made up of the panels. These profiles will be secured by alternate spot welding every 200 mm.
- 2 The first panel will be installed following the established movement sequence.
- 3 The contiguous panel will be installed using the same technique as before, completely tangential to the previous one at the profiled edges.
- 4 The two panels will be joined with the CLIP, which is inserted with gentle pressure in its associated channel.
- 5 Steps 3 and 4 are repeated until the surface to cover is completed.

Fastening examples

We can make any type of fastening, according to the client's requirements.

