

Panels

Panel clip LC B-15

The LC B-15 is a fast modular system of 25 mm thick panels with a fastening system fitted to one of its faces. The design allows simple fast assembly while guaranteeing excellent insulation and an exceptional surface finish.

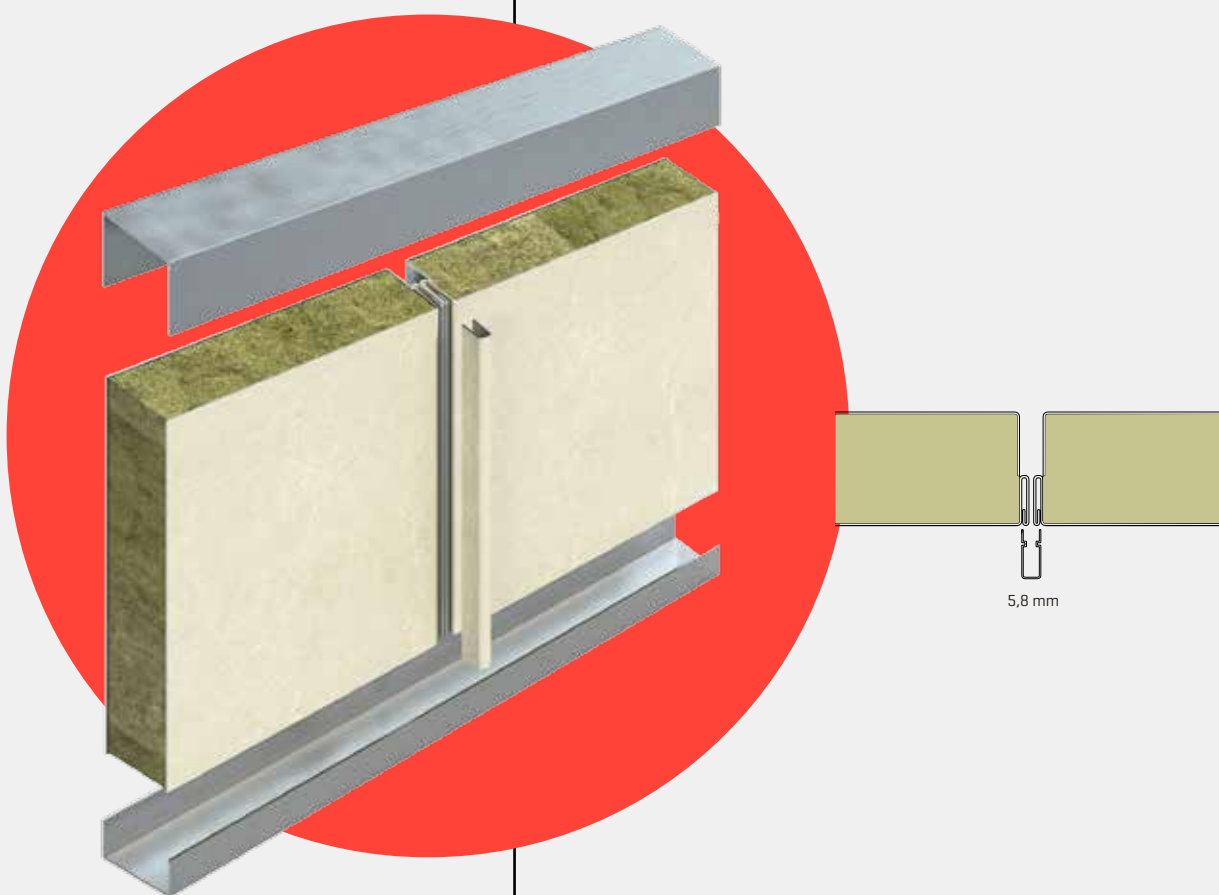

LC B-15

Fire classification	B-15
Standard width	558 mm
Maximum length	Up to 5.000 mm
Width	200-1.188 mm
Thickness	25 mm
Weight	13.7 kg/m ²
Acoustic insulation	Rw=28 dB
Thermal insulation	U=1.14 W/m ² K
Application	Lining



Assembly instructions

- 1 The perimeter outlines are fixed on the floor and the upper vertical outlines on the ceiling. They will determine the securing guide for the bulkhead made up of the panels. These profiles will be secured by alternate spot welding every 200 mm.
- 2 The first panel will be installed following the established movement sequence.
- 3 The contiguous panel will be installed using the same technique as before, completely tangential to the previous one at the profiled edges.
- 4 The two panels will be joined with the CLIP, which is inserted with gentle pressure in its associated channel.
- 5 Steps 3 and 4 are repeated until the surface to cover is completed.

Fastening examples

We can make any type of fastening, according to the client's requirements.

